

L= 45 - 90 cm
W= 17 3/4" - 35 2/4"
P= 35 - 45 cm
D= 13 3/4" - 17 3/4"

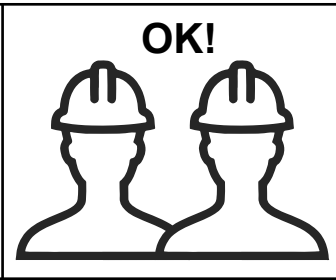

Attrezzi richiesti / Tools Required:

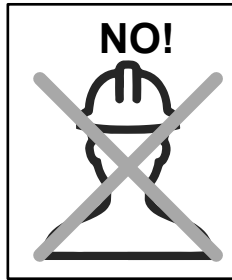
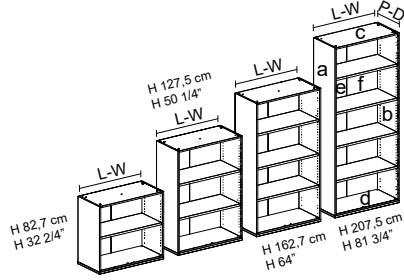
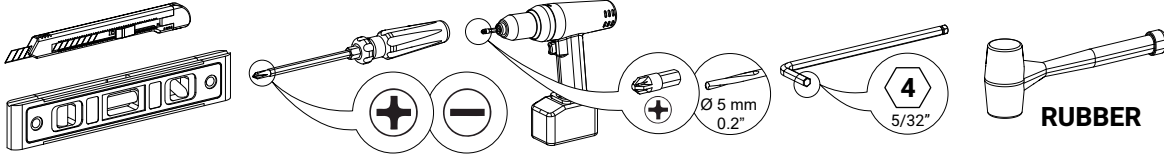

NOTE

ASSEMBLAGGIO / ASSEMBLY



DISASSEMBLAGGIO / DISASSEMBLY

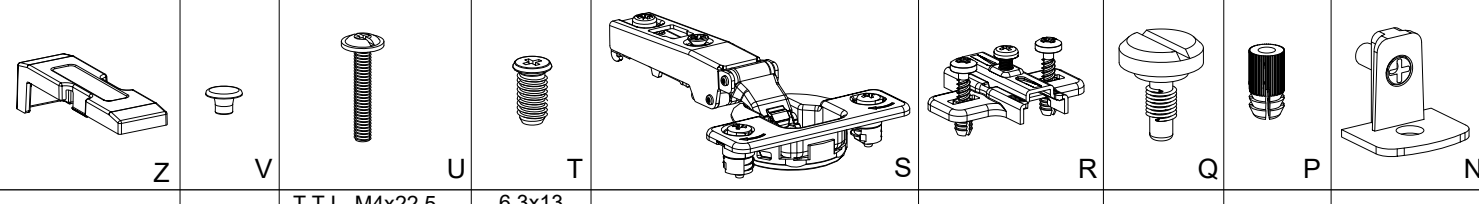
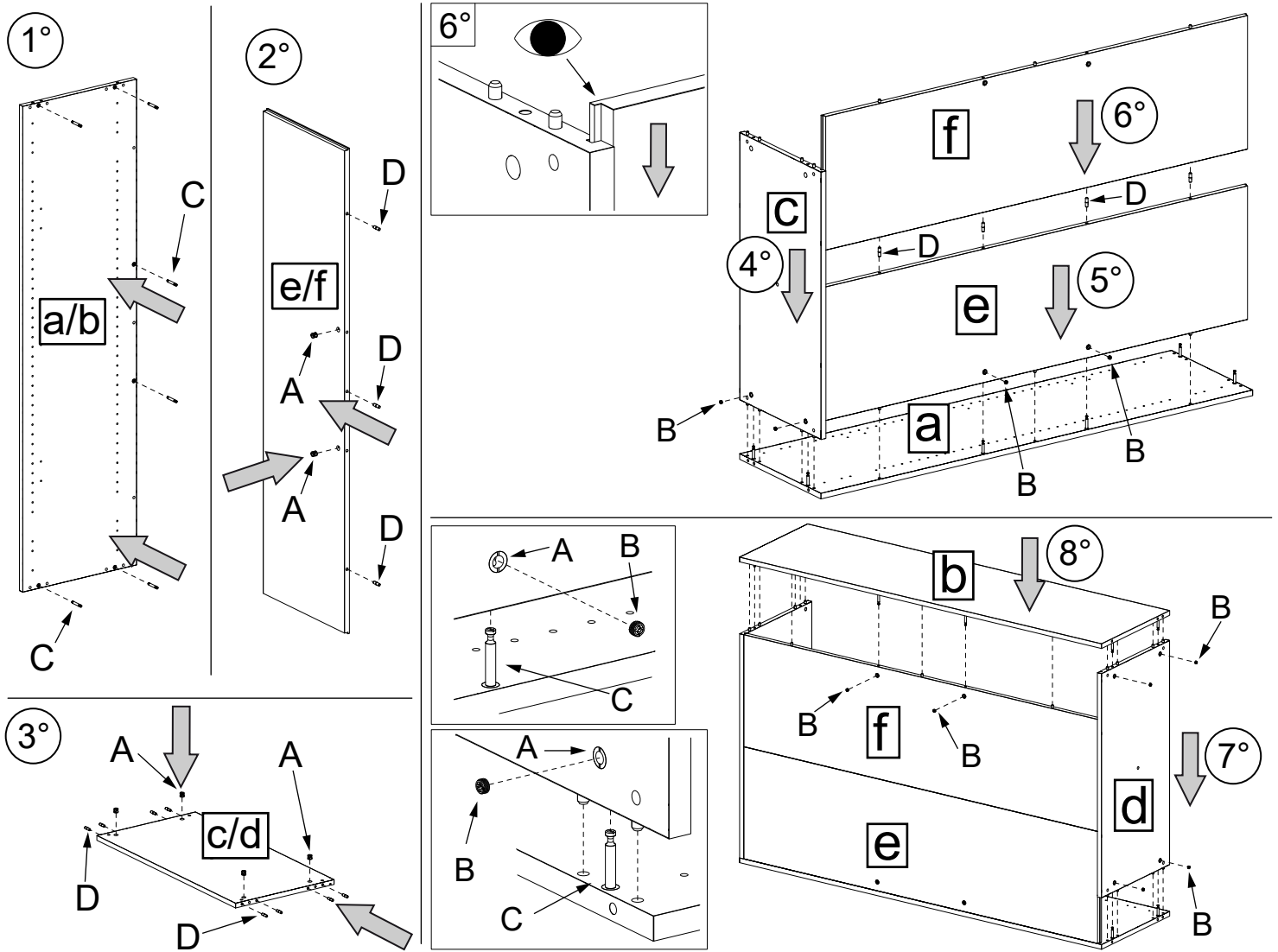

T.T.L. M4x22,5

6,3x13

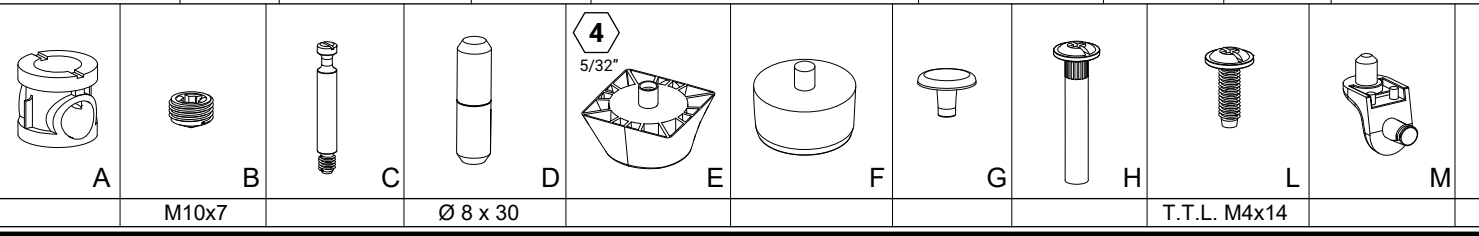

M10x7

Ø 8 x 30

T.T.L. M4x14

9°

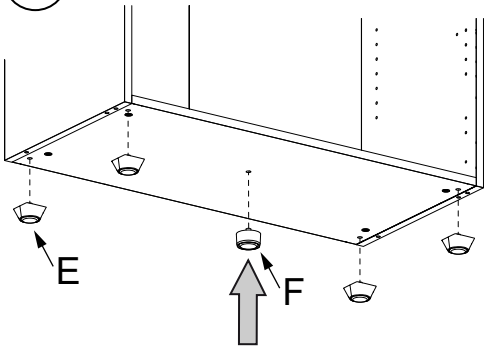

9° OPTIONAL

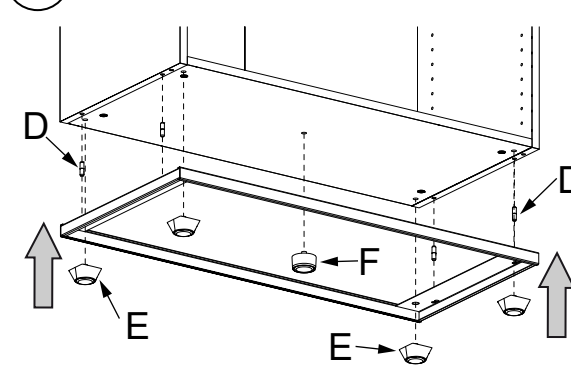

10°

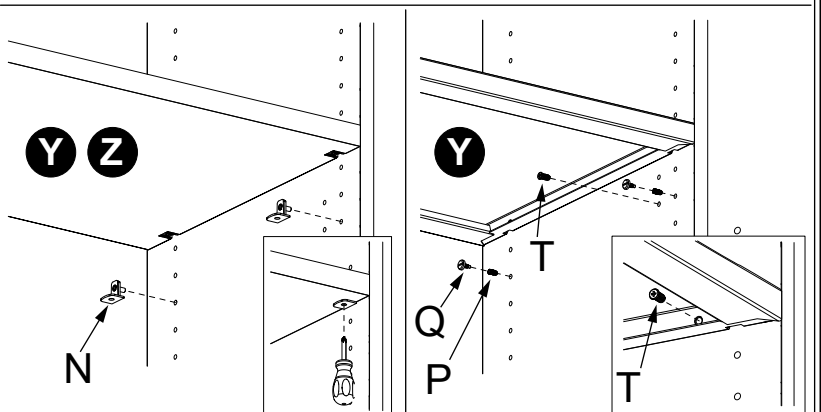
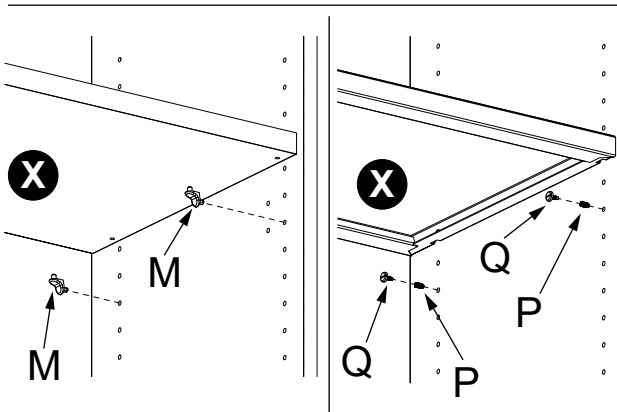
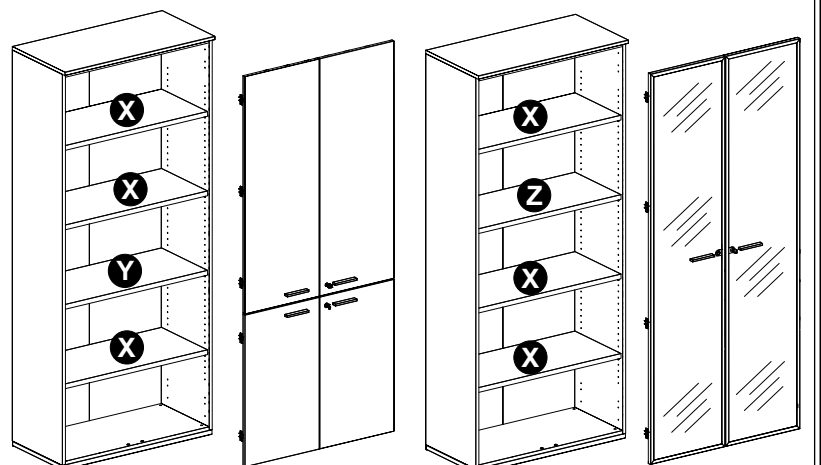
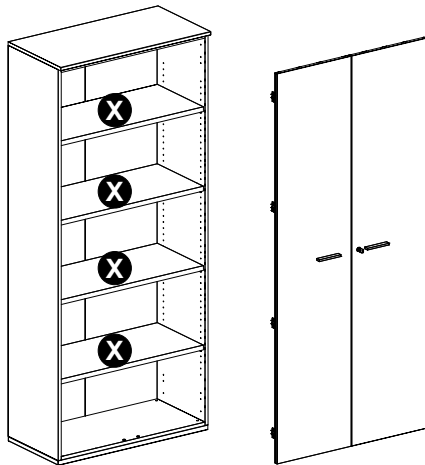
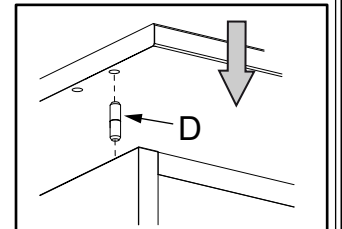
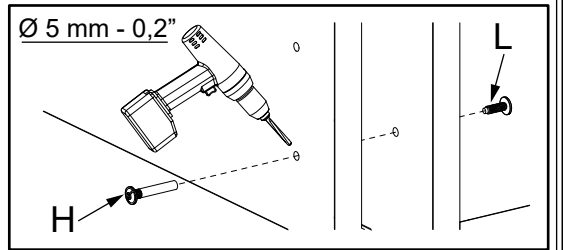
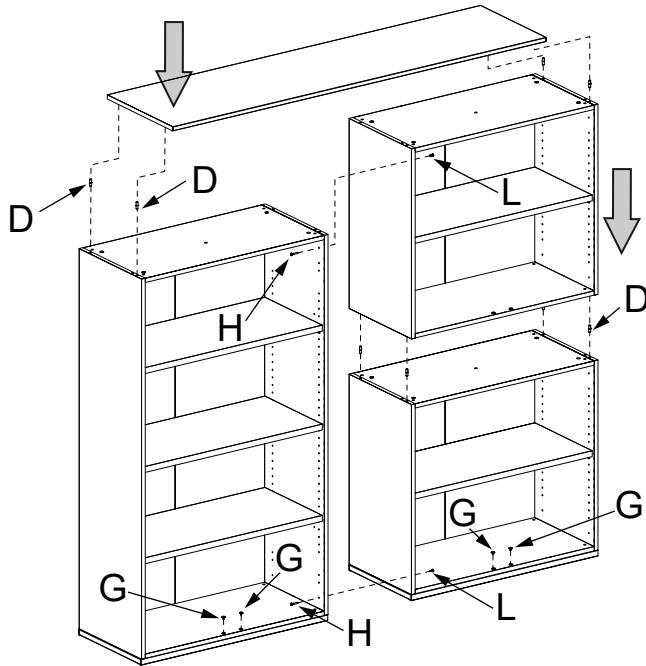
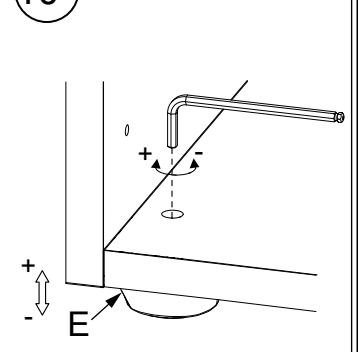

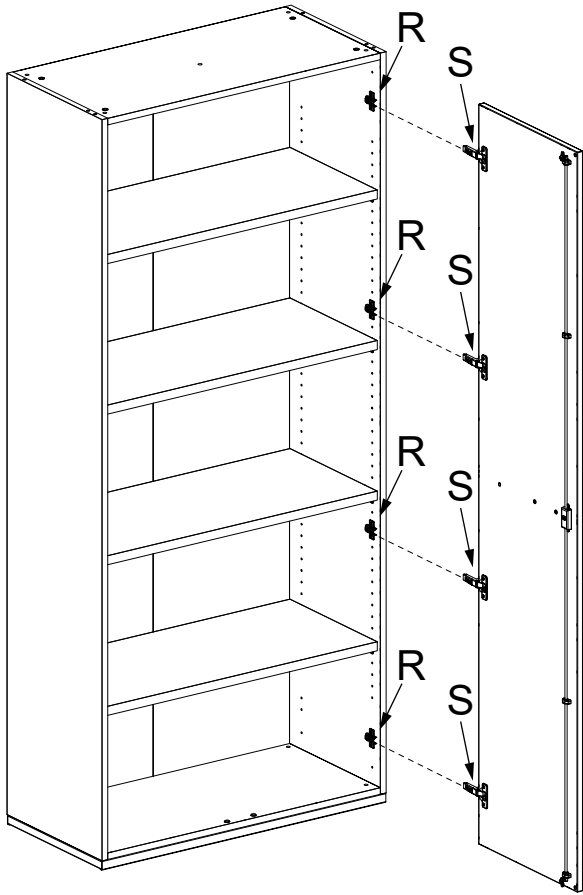

S

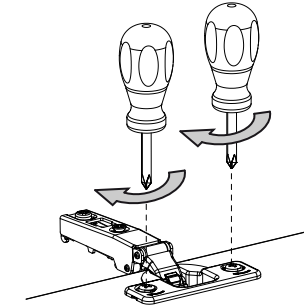
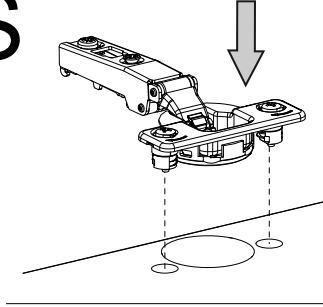

UNLOCK!

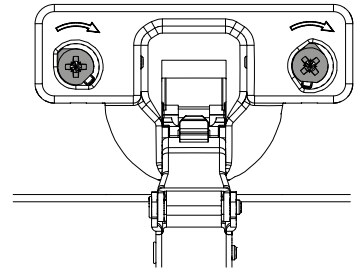

LOCK!

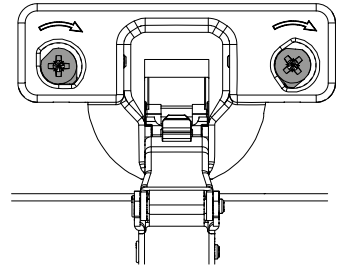

R

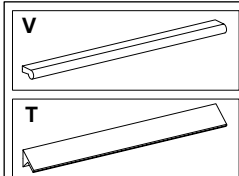
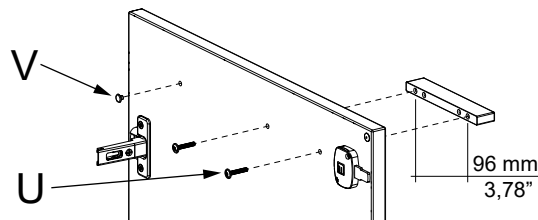
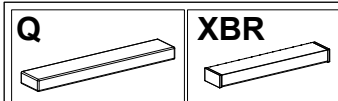
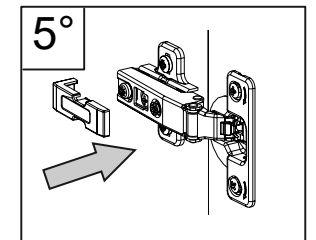
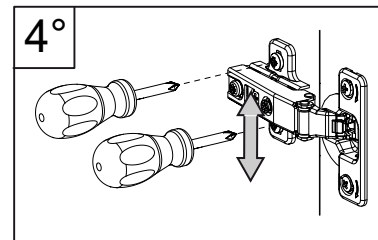
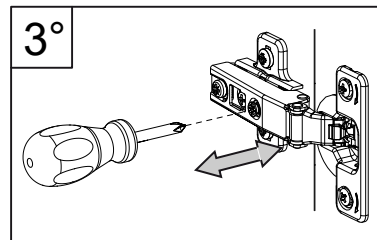
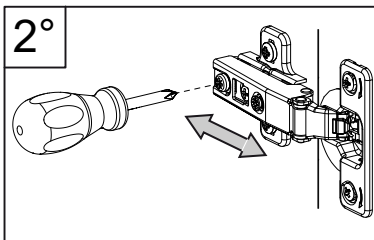
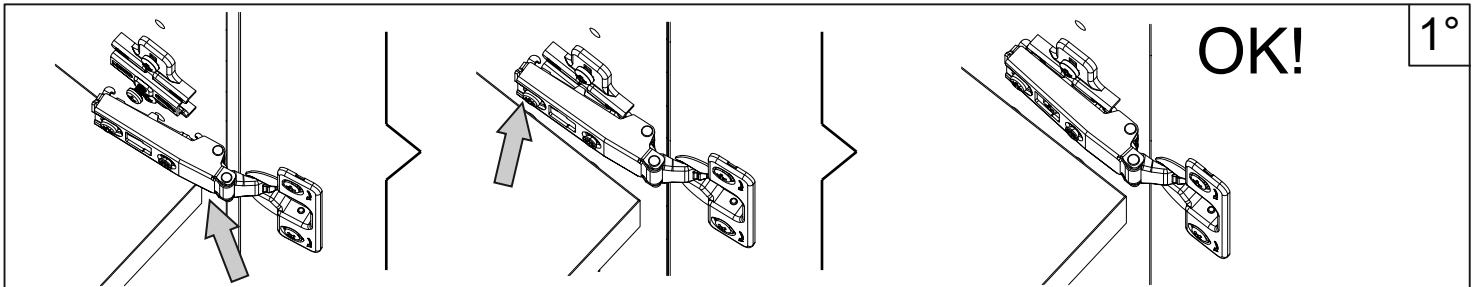
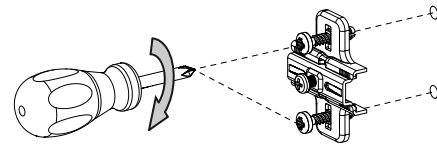

Ø 5 mm - 0,2"

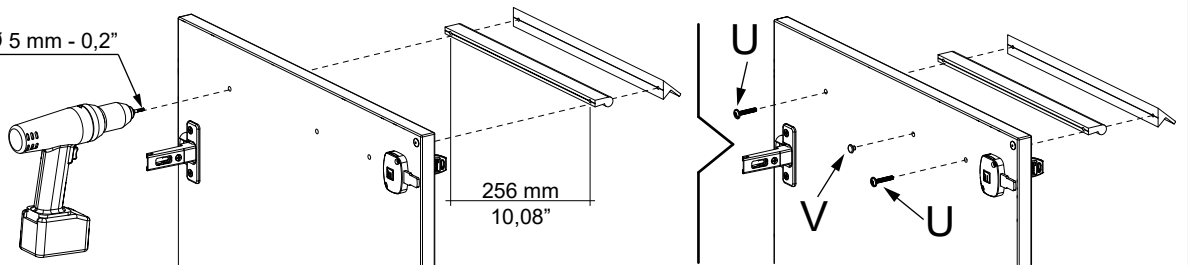

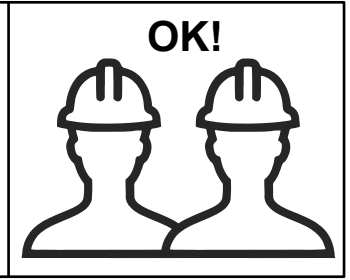
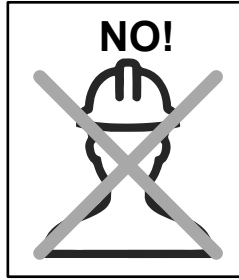
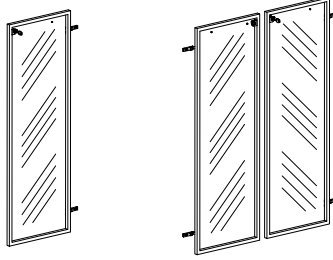

Attrezzi richiesti / Tools Required:

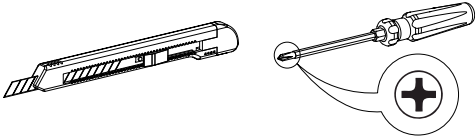

NOTE

ASSEMBLAGGIO
/ ASSEMBLY



DISASSEMBLAGGIO
/ DISASSEMBLY

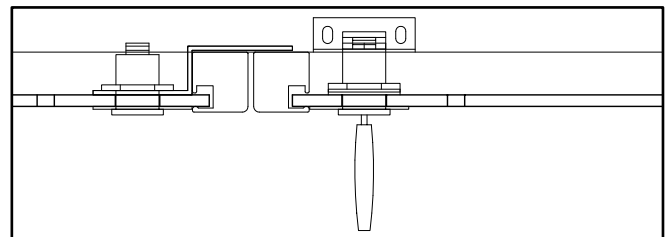
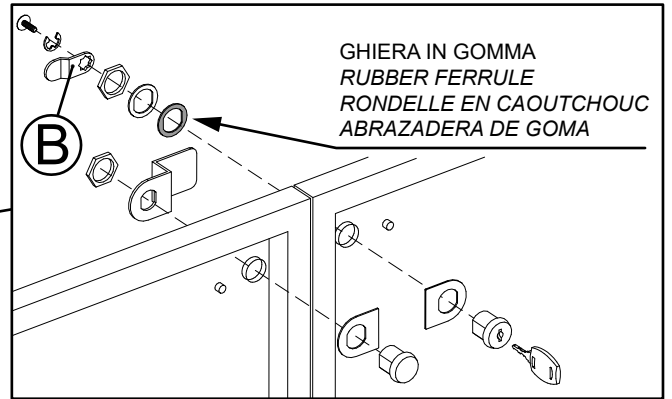
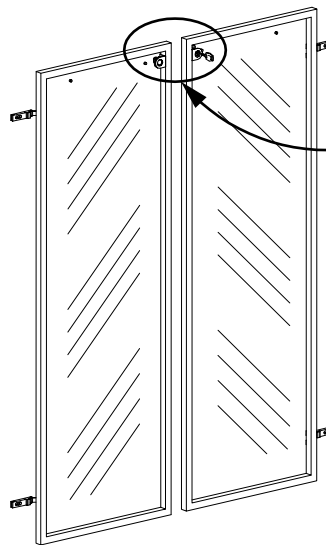
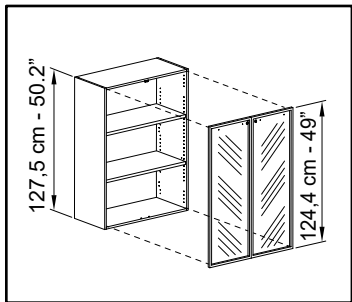
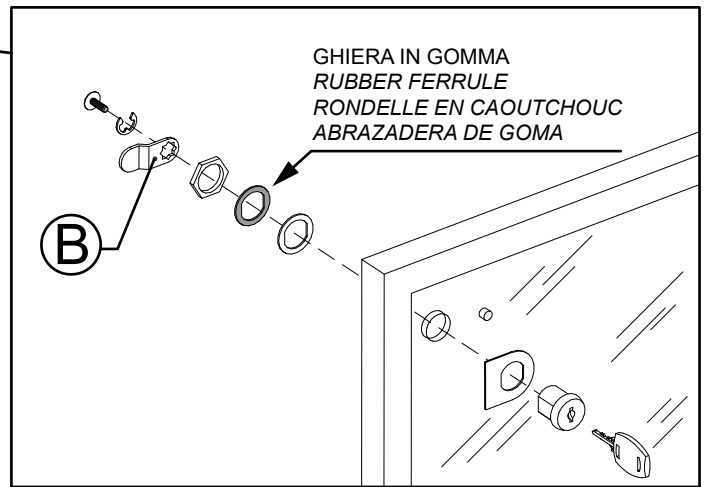
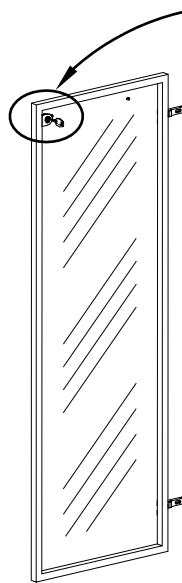
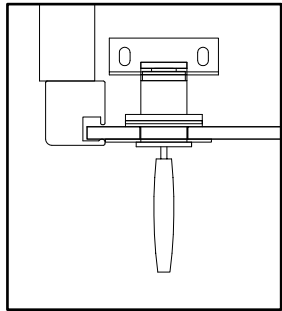
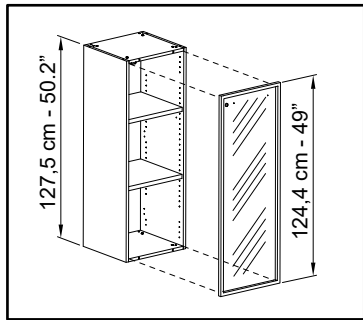

A

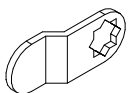

B



C

D

E

F

G

H

L

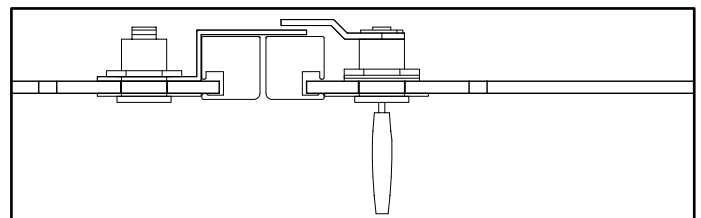
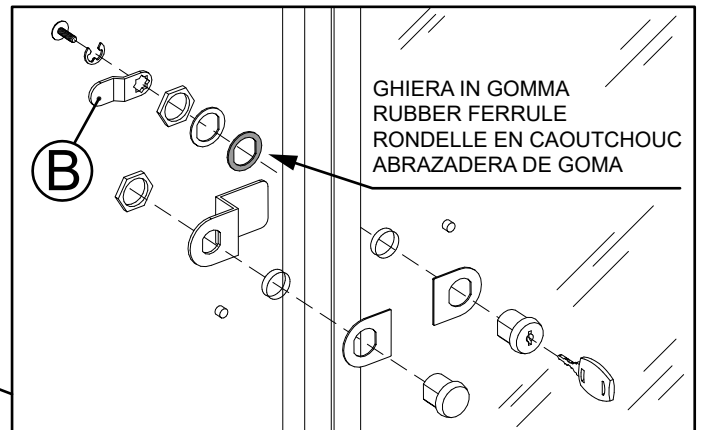
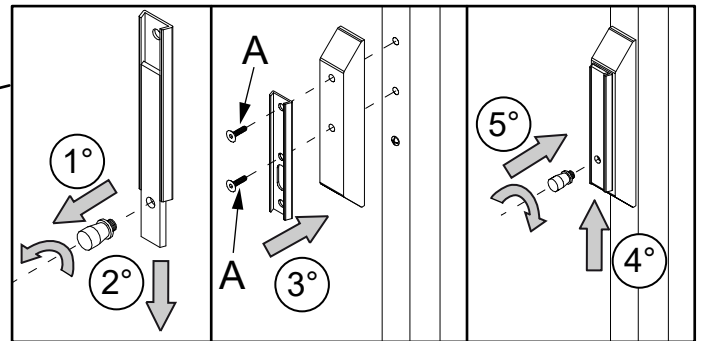
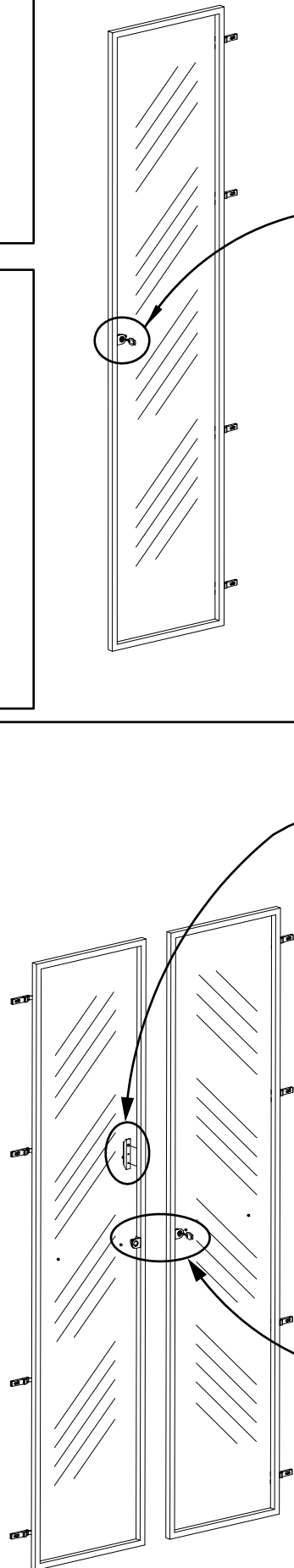
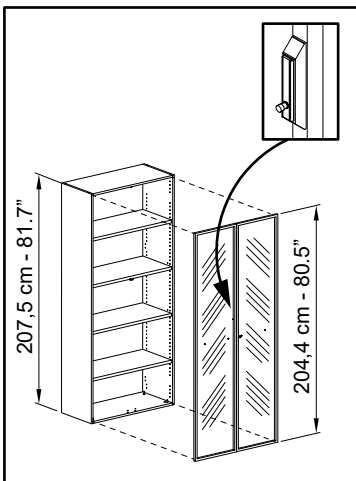
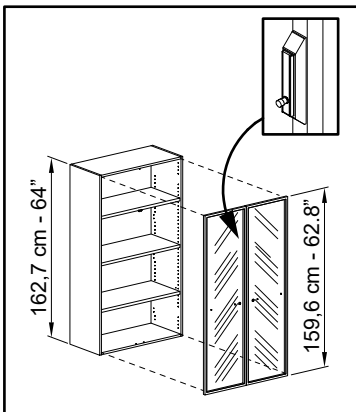
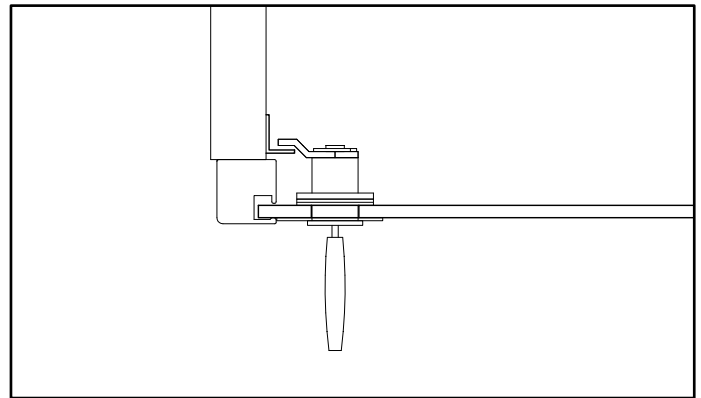
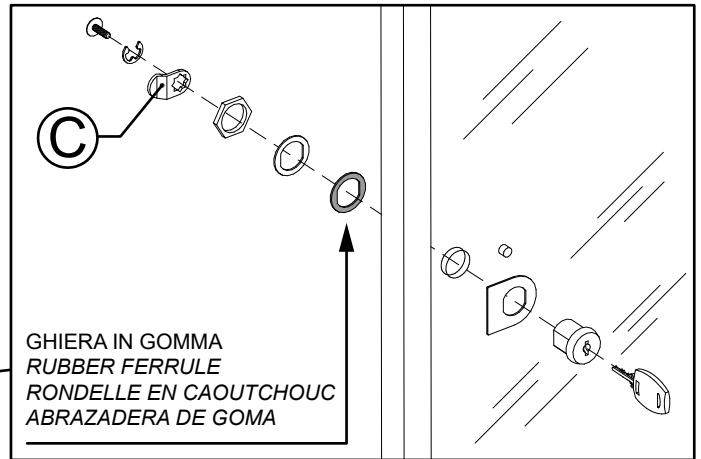
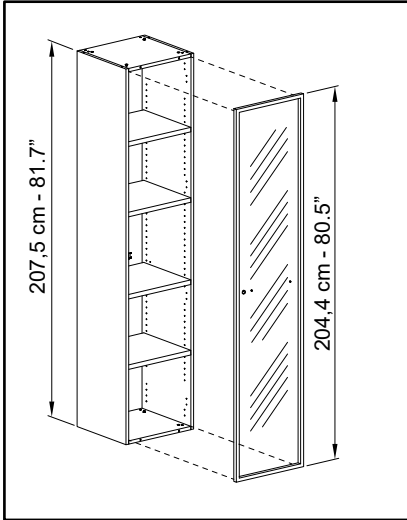
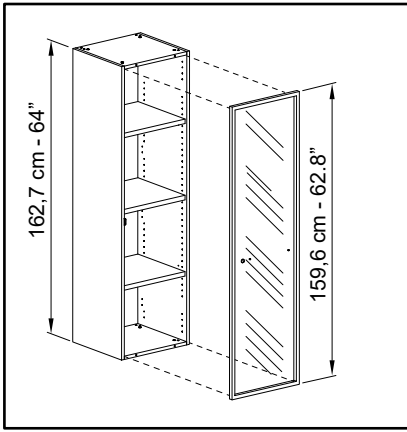

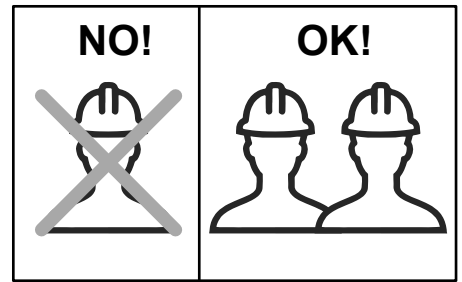
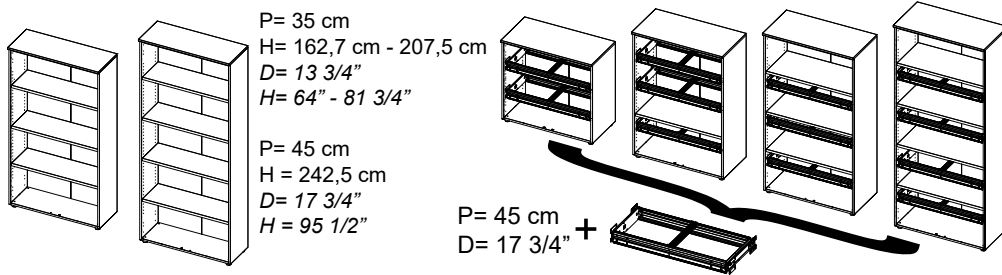

Attrezzi richiesti / Tools Required:

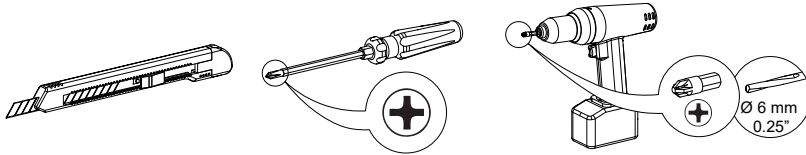

NOTE

ASSEMBLAGGIO / ASSEMBLY

DISASSEMBLAGGIO / DISASSEMBLY

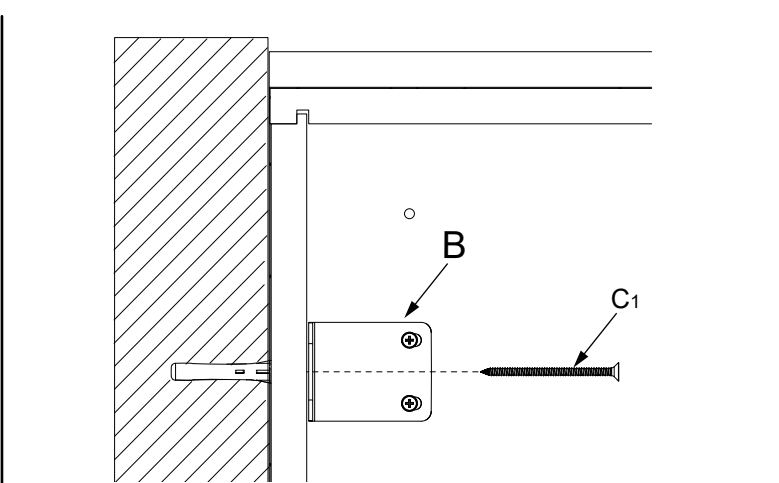
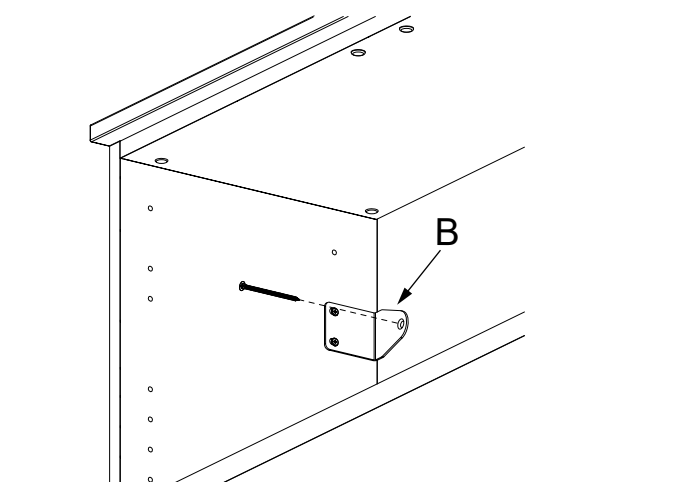
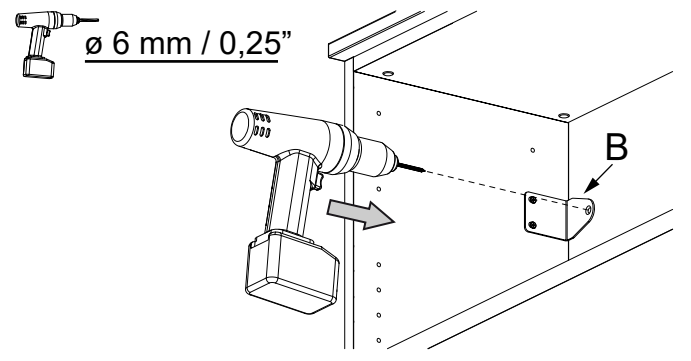
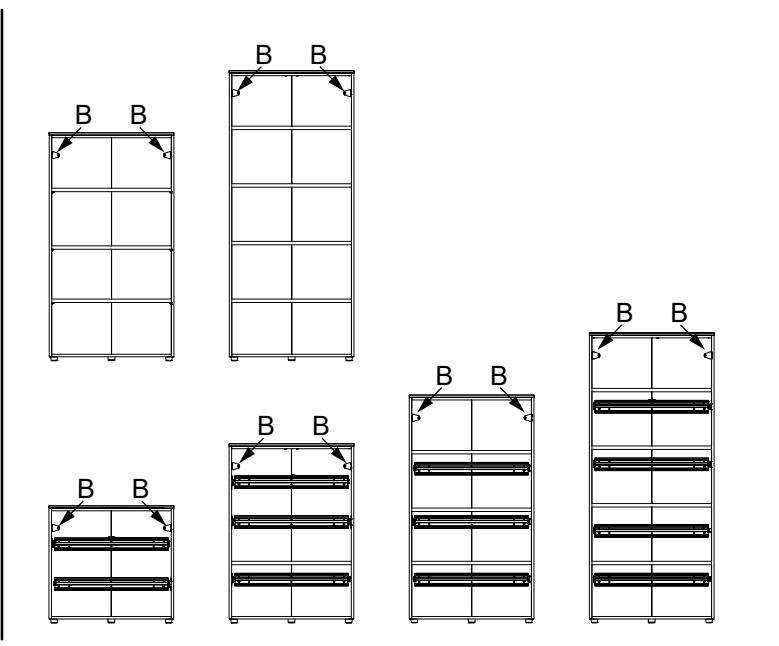
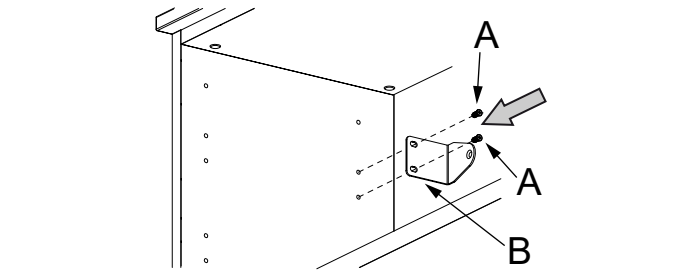

H1 - H2 :Sceglierli in base alle caratteristiche strutturali del muro e a quelle dettate dal costruttore di tasselli / Choose them based on the structural characteristics of the wall and those dictated by the manufacturer of the screw anchors / Elegir según las características estructurales de la pared y las indicaciones de proveedor de los tacos / Doit les choisir en fonction des caractéristiques structurelles du mur et à celles imposées par le producteur des chevilles / Sie müssen vom Kunden gemäß Wandeigenschaften und Anweisungen des Dübel Herstellers besorget werden / Devem ser escolhidas com base nas características estruturais da parede e as normas ditadas pelo fabricante das buchas.

A	B	C1	D	E	F	G	H	L	
6,3x13									
		C2							

LEGENDA / LEGEND	RIFIUTO / WASTE
FONDO IN CONGLOMERATO LIGNEO CON RIVESTIMENTO IN MELAMINICO / <i>WOOD CONGLOMERATE BASE WITH MELAMINE COVERING</i>	LEGNO / <i>WOOD</i>
COPERCHIO IN CONGLOMERATO LIGNEO CON RIVESTIMENTO IN MELAMINICO / <i>WOOD CONGLOMERATE TOP WITH MELAMINE COVERING</i>	LEGNO / <i>WOOD</i>
FIANCHI IN CONGLOMERATO LIGNEO CON RIVESTIMENTO IN MELAMINICO / <i>WOOD CONGLOMERATE LATERL SIDES WITH MELAMINE COVERING</i>	LEGNO / <i>WOOD</i>
SCHIENE IN CONGLOMERATO LIGNEO CON RIVESTIMENTO IN MELAMINICO / <i>WOOD CONGLOMERATE BACK PANEL WITH MELAMINE COATING</i>	LEGNO / <i>WOOD</i>
TOP DI FINITURA IN CONGLOMERATO LIGNEO CON RIVESTIMENTO IN MELAMINICO / <i>WOOD CONGLOMERATE FINISHING TOP WITH MELAMINE COATING</i>	LEGNO / <i>WOOD</i>
RIPIANI IN CONGLOMERATO LIGNEO CON RIVESTIMENTO IN MELAMINICO / <i>WOOD CONGLOMERATE SHELVES WITH MELAMINE COATING</i>	LEGNO / <i>WOOD</i>
RIPIANI IN METALLO VERNICIATI CON POLEVRI EPOSSIDICHE / <i>METAL SHEET SHELVES VARNISHED WITH EPOXY POWDERS</i>	METALLO / <i>METAL</i>
ZOCOLO METALLICO SALDATO VERNICIATO CON POLEVRI EPOSSIDICHE / <i>METAL SHEET PLINTH WELDED AND VARNISHED WITH EPOXY POWDERS</i>	METALLO / <i>METAL</i>
PIEDINI LIVELLATORI IN ABS / <i>ABS LEVELING FEET</i>	PLASTICA / <i>PLASTIC</i>
ANTE IN CONGLOMERATO LIGNEO CON RIVESTIMENTO IN MELAMINICO / <i>WOOD CONGLOMERATE DOORS WITH MELAMINE COATING</i>	LEGNO / <i>WOOD</i>
ANTE IN VETRO ACIDATO TEMPRATO CON TELAIO IN ALLUMINIO SP. 20 MM / <i>TEMPERED ACETATED GLASS DOORS WITH 20 MM THICK ALUMINUM FRAME</i>	VETRO-METALLO / <i>GLASS - METAL</i>
ANTE IN VETRO RETROLACCATO TEMPRATO CON TELAIO IN ALLUMINIO SP. 20 MM / <i>TEMPERED BACK-LACQUERED GLASS DOORS WITH ALUMINUM FRAME 20 MM TH</i>	VETRO-METALLO / <i>GLASS - METAL</i>
MANIGLIA IN PRESSOFUSIONE DI ZAMA / <i>DIE-CAST ZAMAK HANDLE</i>	METALLO / <i>METAL</i>
CERNIERA IN METALLO / <i>METAL HINGES</i>	METALLO / <i>METAL</i>
SERRATURA / <i>LOCK</i>	METALLO / <i>METAL</i>