

Min. 64,5 cm - 25 6/16"  
Max. 130 cm - 51 3/16"

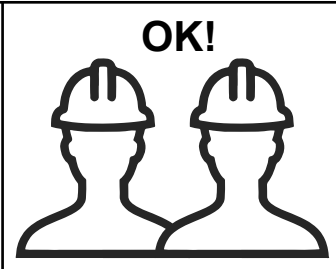

Attrezzi richiesti / Tools Required:

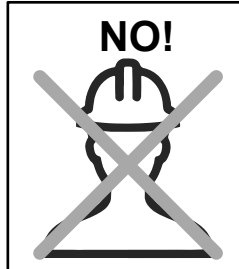
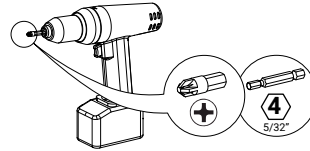
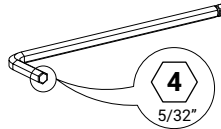
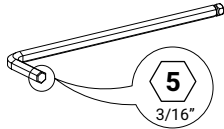
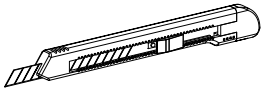

NOTE

ASSEMBLAGGIO / ASSEMBLY



DISASSEMBLAGGIO / DISASSEMBLY

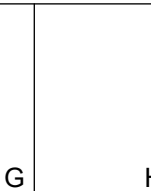
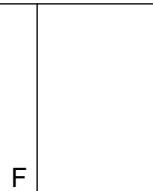
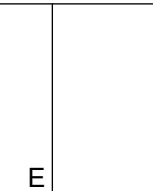
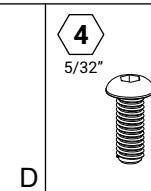
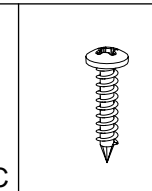
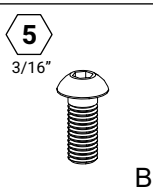
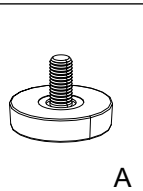
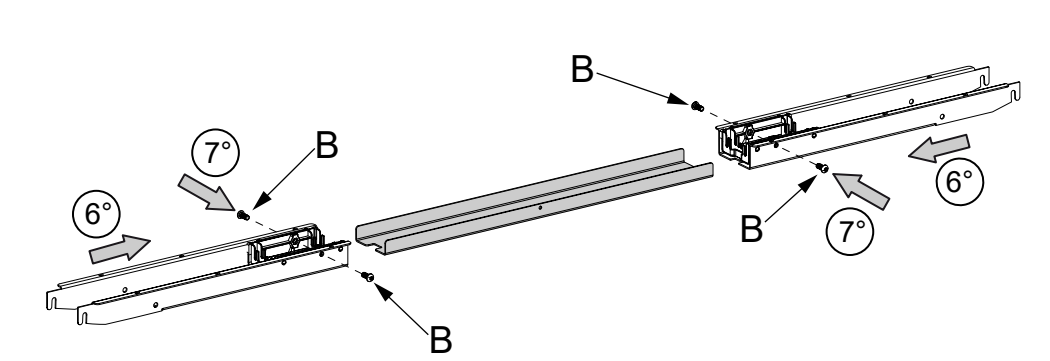
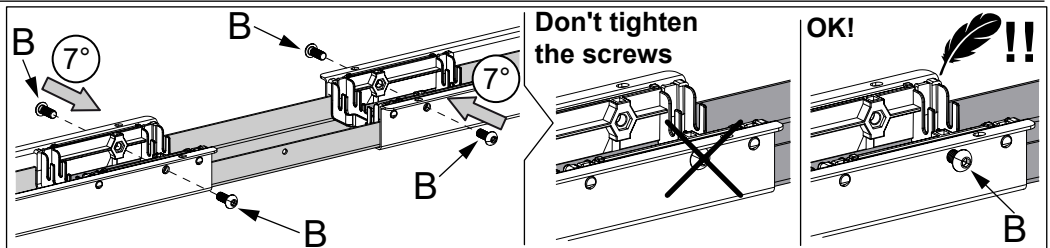
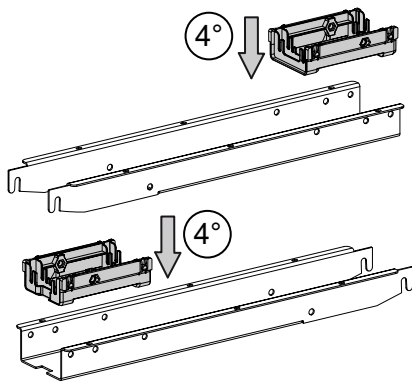
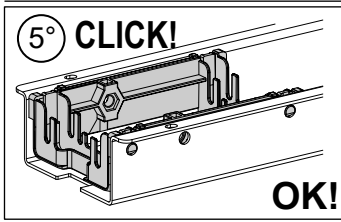
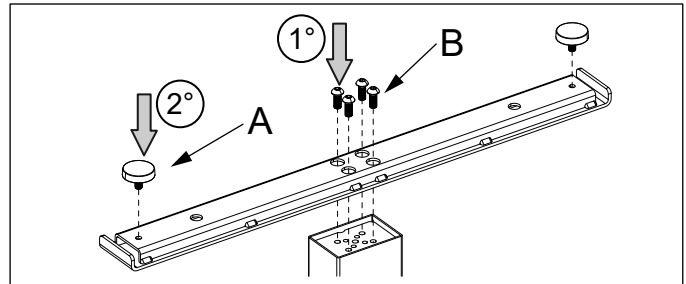
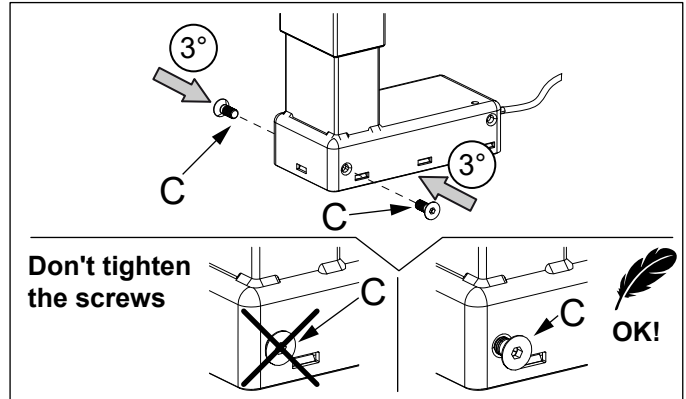
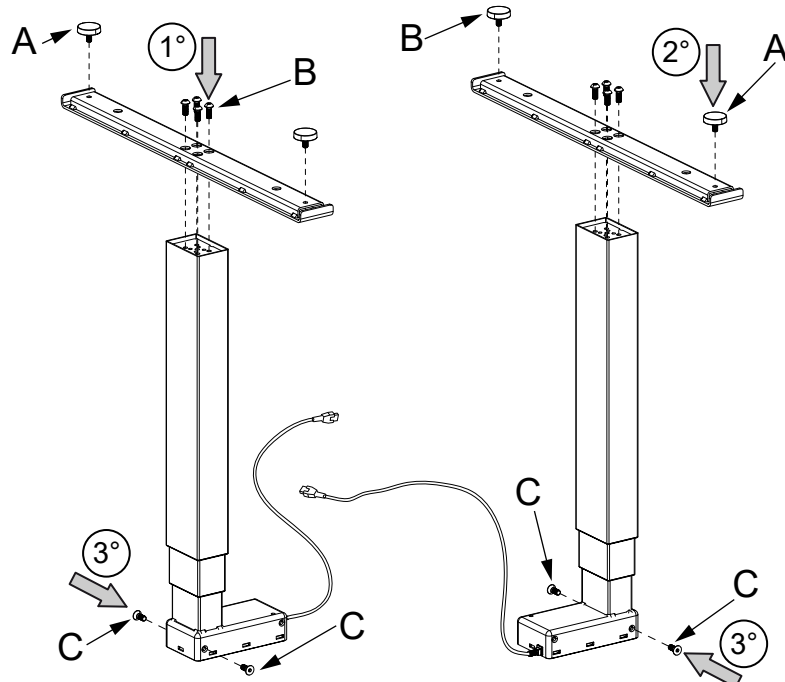

A T.B.E.I. M8x20 B T.S.P.E.I. M8x20 C T.C.I.C. Ø4,2x20 D T.B.E.I. M6x16 E F G H I L

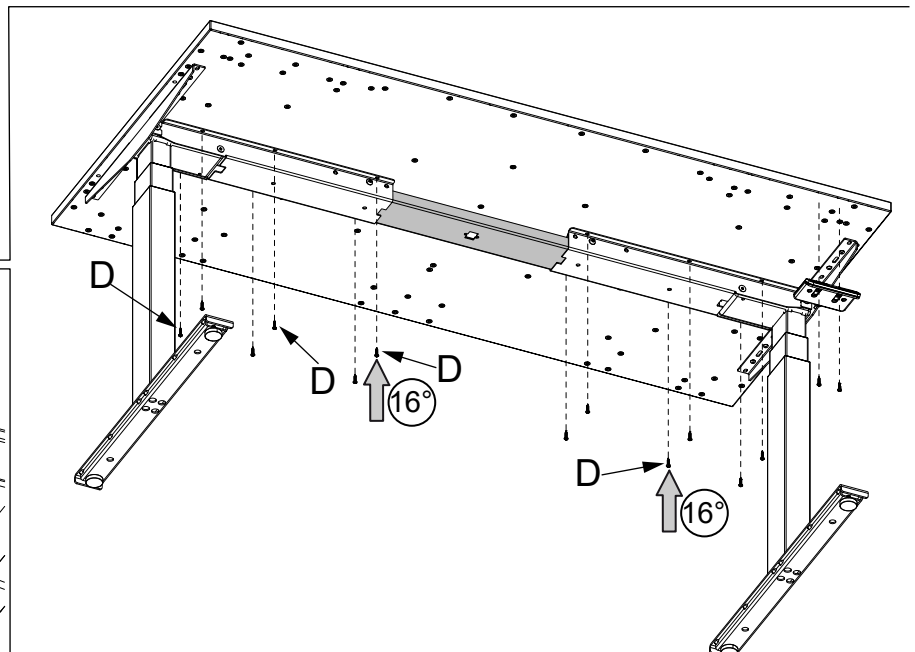
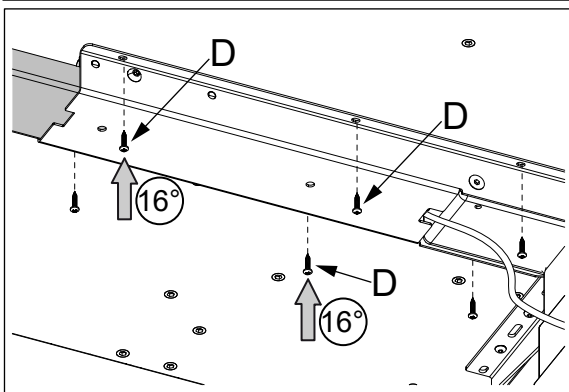
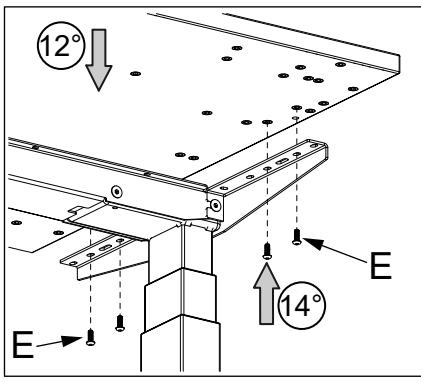
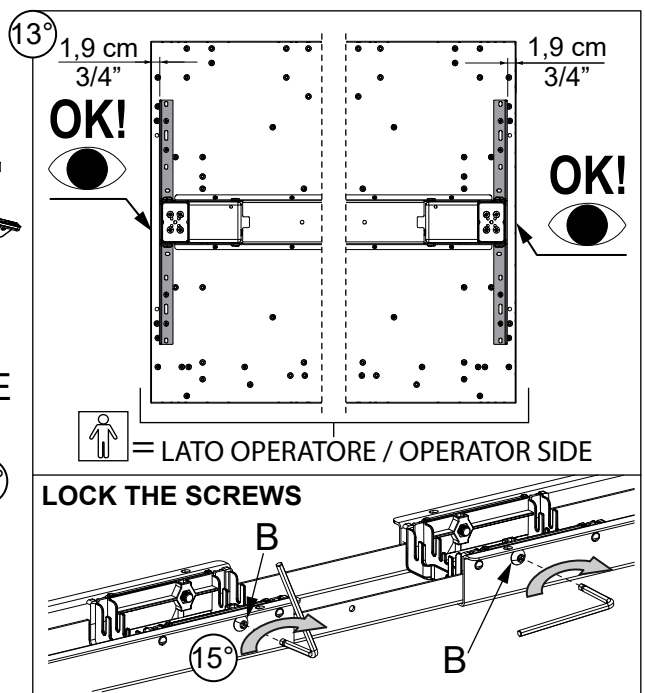
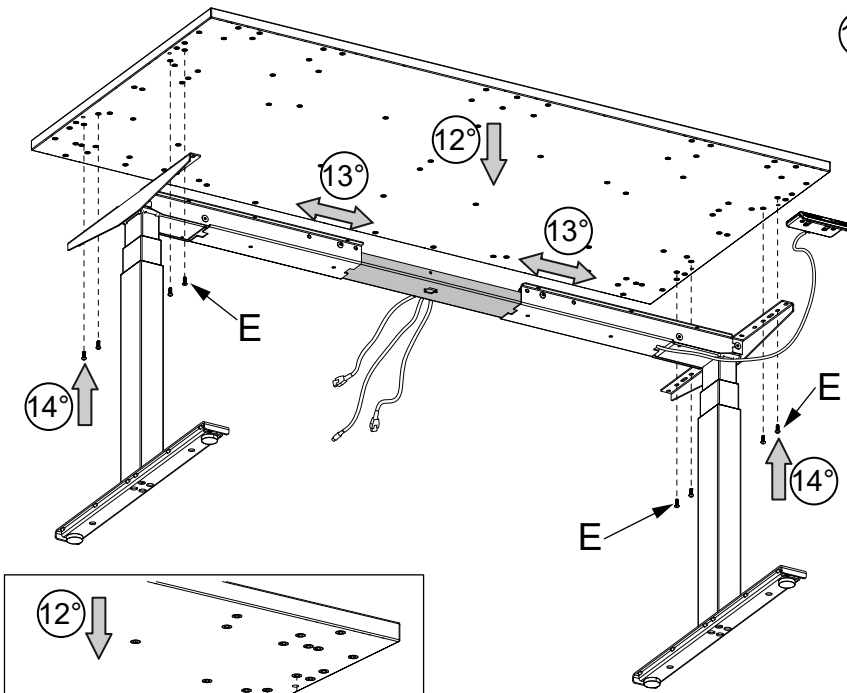
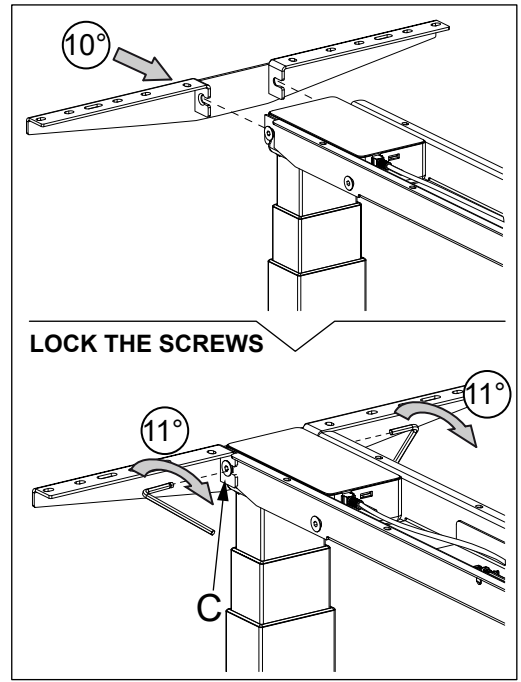
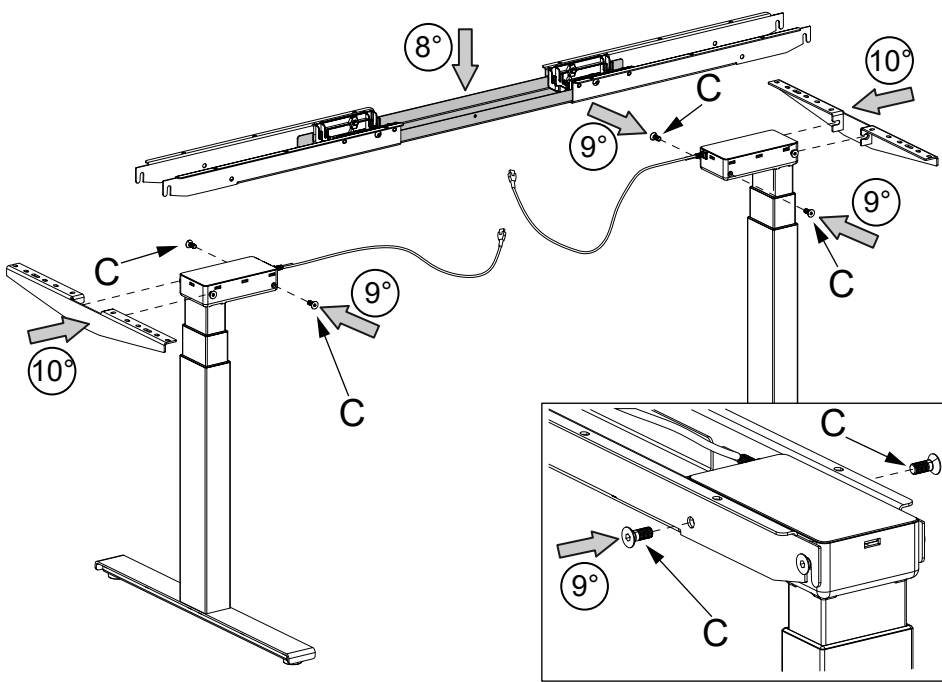

E' OBBLIGATORIO MONTARE LA CENTRALINA SOTTO IL PIANO DI LAVORO PRIMA DI COLLEGARE LA SCRIVANIA ALL'ALIMENTAZIONE ELETTRICA.

IT IS MANDATORY TO ASSEMBLE THE CONTROL UNIT UNDER THE WORKTOP BEFORE CONNECTING THE DESK TO THE ELECTRIC POWER SUPPLY.

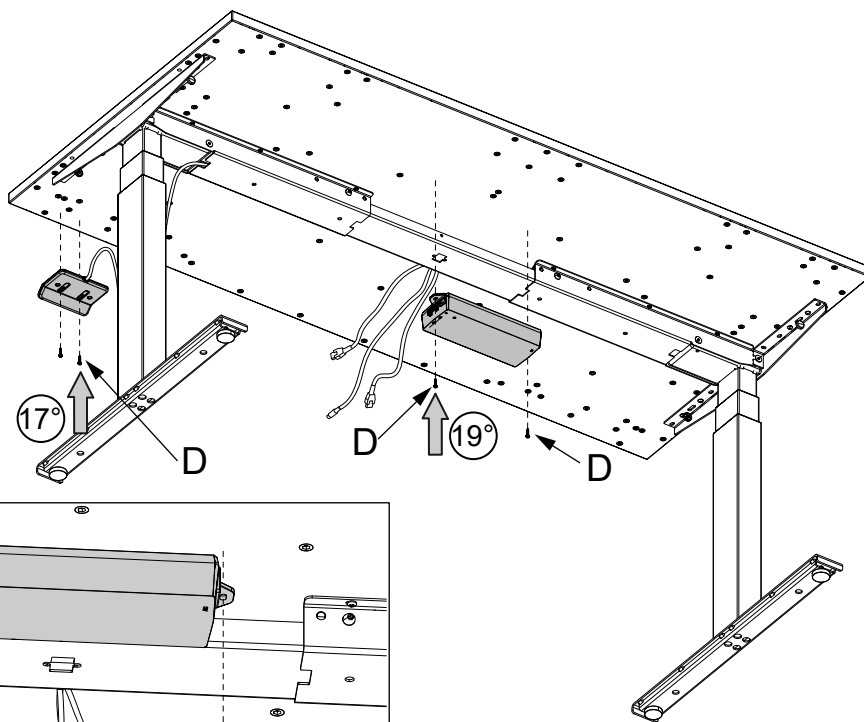
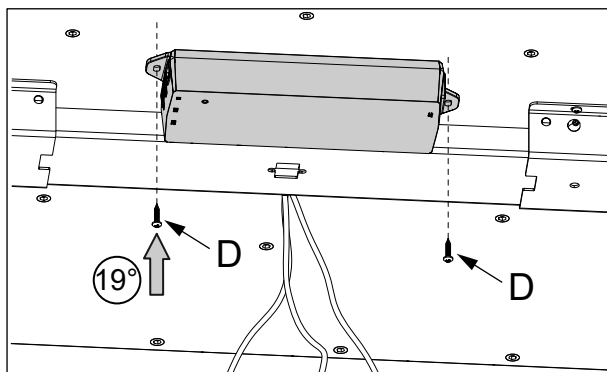
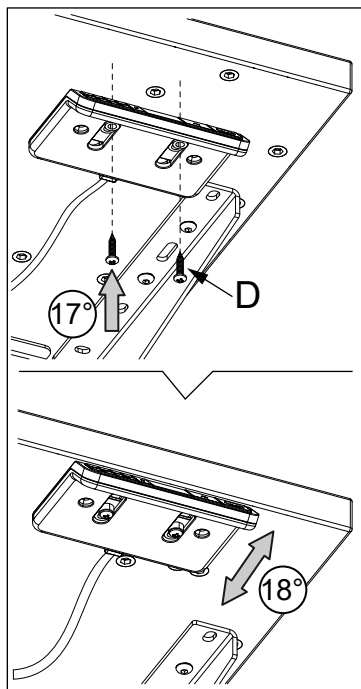

20°

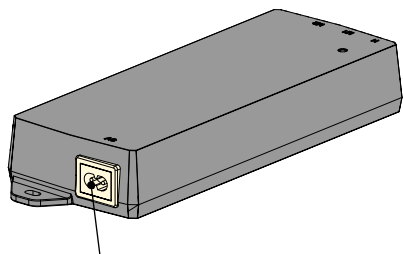

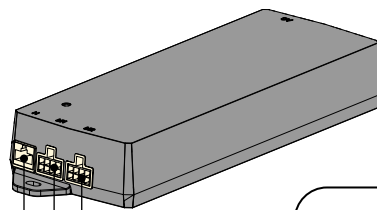

Collegamento alla rete elettrica /  
Mains power supply connection



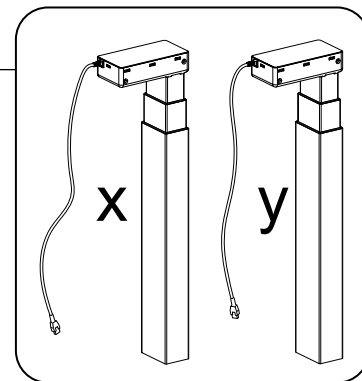
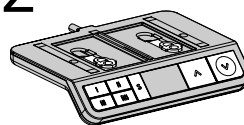

Z







## 21° STANDARD RESET:

- 1- Collegare la spina alla rete elettrica.
- 2- Portare la scrivania ad altezza minima premendo il pulsante 
- 3- Rilasciare il pulsante 
- 4- Ripremere il pulsante  e tenerlo premuto per 10 sec.
- 5- Il reset sarà così completato.

- 1- Connect the plug into the power grid.
- 2- Lower the desk to the minimum height by using the button 
- 3- Release the button 
- 4- Push the button  again and keep it pressed for 10 seconds.
- 5- Reset is completed.

## 21° RESET:

- 1- Collegare la spina alla rete elettrica.
- 2- Premere simultaneamente i pulsanti   e tenerli premuti per 10 sec.
- 3- Il reset sarà così completato.

- 1- Connect the plug into the power grid.
- 2- Push both buttons   and keep it pressed for 10 seconds.
- 5- Reset is completed.

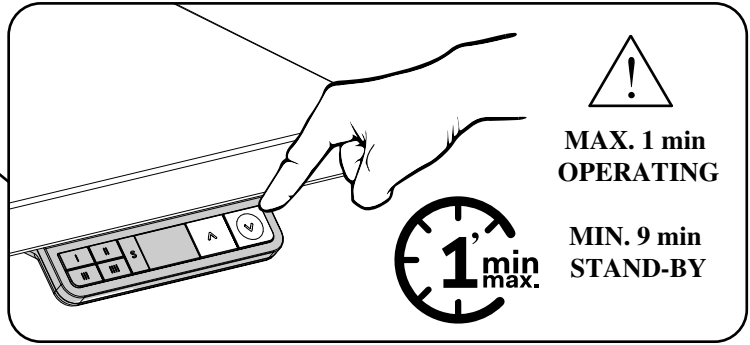
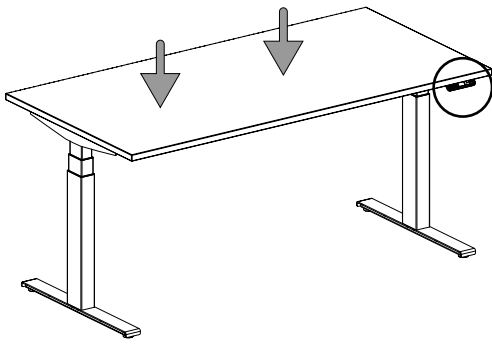

**INCH or CENTIMETERS:**

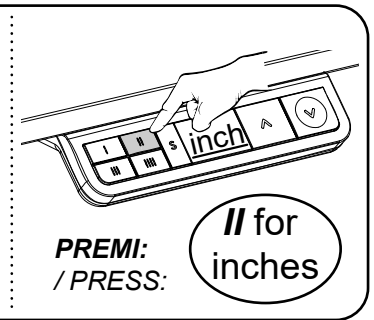
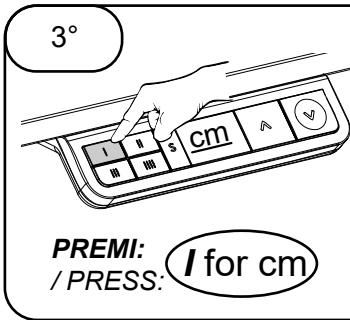
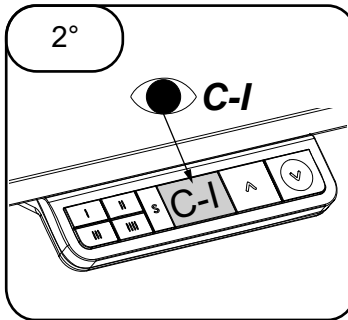
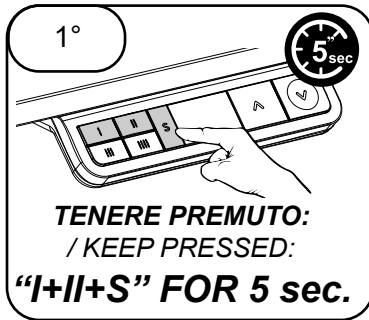
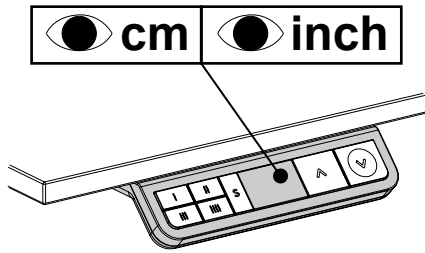

**MEMORIE ALTEZZE - HEIGHTS MEMORIES:**

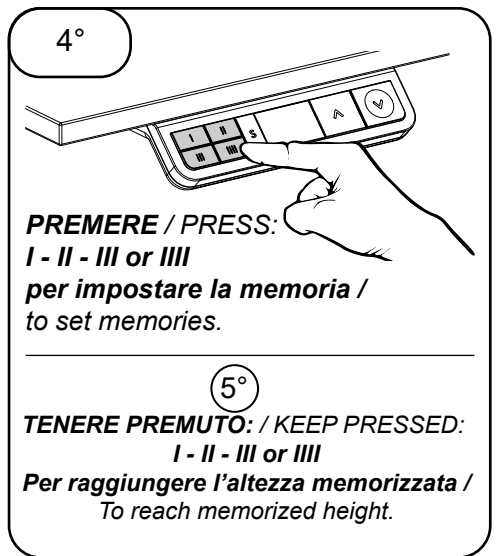
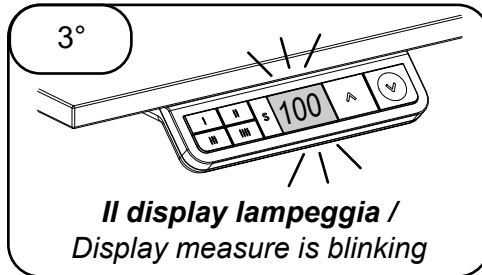
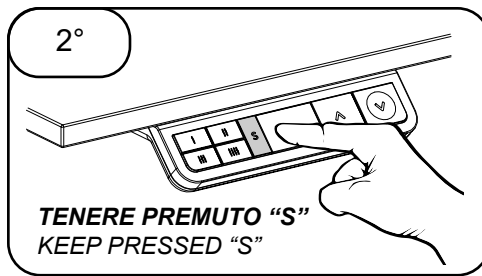

**LEGENDA / LEGEND**

BASAMENTO E TRAVERSO METALLICO VERNICIATO CON POLVERI EPOSSIDICHE / METALLIC BASE AND CROSSBEAM VARNISHED WITH EPOSSIDIC POWDER
TAPPI DI COPERTURA IN ABS / ABS COVER CAPS
TRAVE METALLICA / METALLIC BEAM
PIANO DI LAVORO IN CONGLOMERATO LIGNEO CON RIVESTIMENTO IN MELAMINICO / WOOD CONGLOMERATE WORKTOP WITH MELAMINE COATING
PARTICOLARI IN ABS / ABS ARTICLES
PIEDINI LIVELLATORI IN ABS CON FILETTO IN METALLO / ABS LEVELING FEET WITH METAL THREAD
COMPONENTI ELETTRICI / ELECTRICAL COMPONENTS

**RIFIUTO / WASTE**

METALLO / METAL
PLASTICA / PLASTIC
METALLO / METAL
LEGNO / WOOD
PLASTICA / PLASTIC
RIFIUTO SPECIALE / SPECIAL WASTE