

Schema dimensionale parete divisoria / Scheme of partition dimensions

P 10

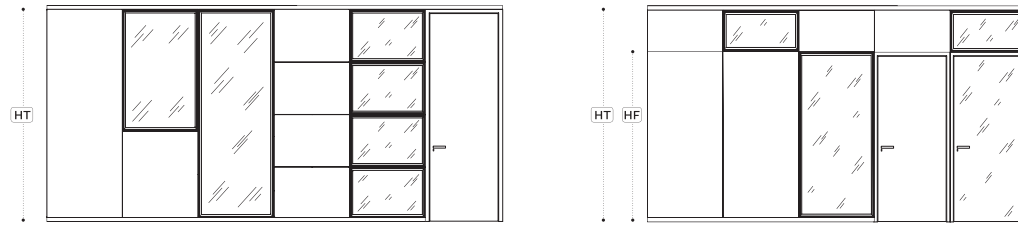

Tipologia: / Type: "L" - Low HF=220 cm
 "M" - Medium HF= 252 cm
 "H" - High HF= 268 cm

Moduli tutta altezza / Module full height

HT = Altezza totale / Total height

HF = Altezza filo parete / Upper line

Schema dimensionale parete divisoria / Scheme of partition dimensions

P 10

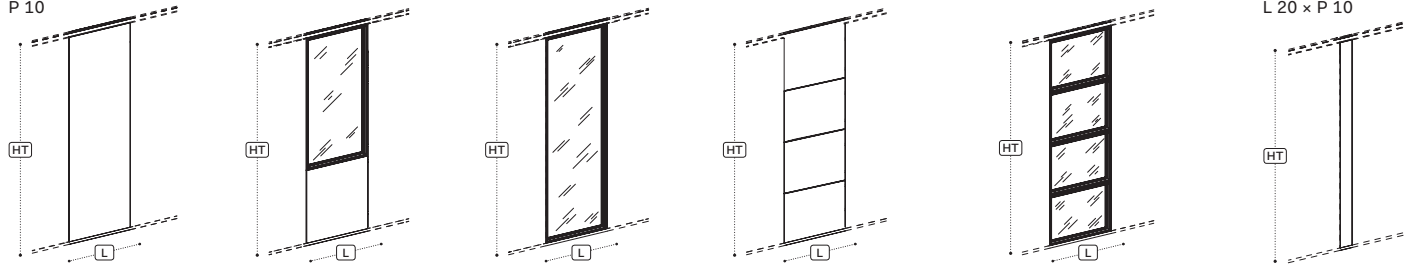

Moduli divisori ciechi / Panelled partitions

L = 50 - 60 - 80 - 100 - 120

Moduli divisori ciechi-vetro / Panelled-glass partitions

L = 50 - 60 - 80 - 100 - 120

Moduli divisori vetro / Glass partitions

L = 50 - 60 - 80 - 100 - 120

Moduli divisori ciechi a mattonella / Panelled "bricks shaped" partitions

L = 50 - 60 - 80 - 100 - 120
 - 140 - 160 - 180 - 200 - 220

Moduli divisori vetro a mattonella / Glass "bricks shaped" partitions

L = 50 - 60 - 80 - 100 - 120
 - 140 - 160 - 180 - 200 - 22

Modulo tecnico per passaggio cavi / Wire management technical module

Porte/Doors

L 100 x P 10

L 100 x P 18,5

L 200 x P 10

L 200 x P 18,5

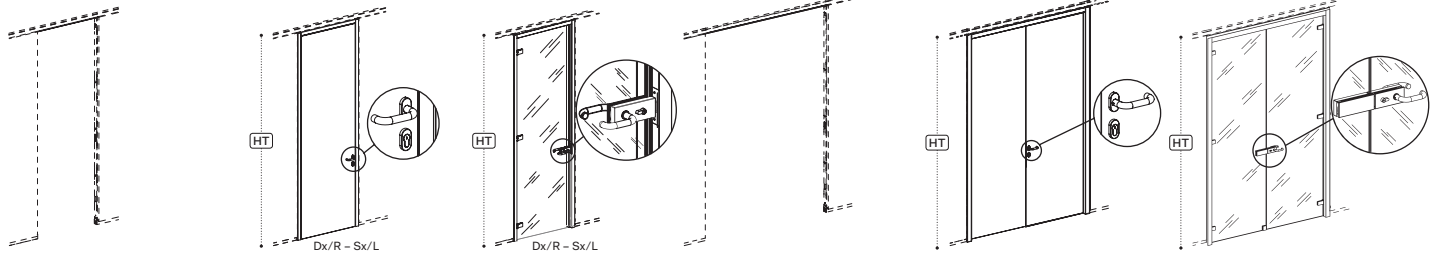

Modulo passaggio porta singola / Single door top module

Porta anta battente cieca / Single hinged panelled door

Porta anta battente vetro / Single hinged glass door

Modulo passaggio porta doppia / Double door top module

Porta doppia anta battente cieca / Double hinged panelled door

Porta doppia anta battente vetro / Double hinged glass door

Fasce di tamponamento/Fillers

L < 30 P 10

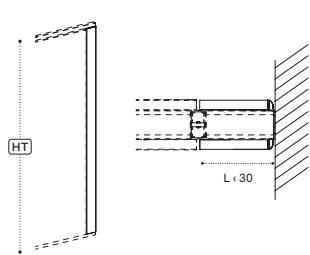

Angoli e testate/Corner and terminal profiles

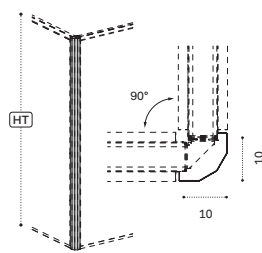

Carter metallico per angoli a 90° / Metal casing for 90° corners

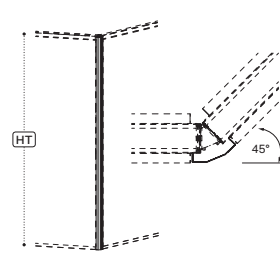

Carter metallico per angoli a 45° / Metal casing for 45° corners

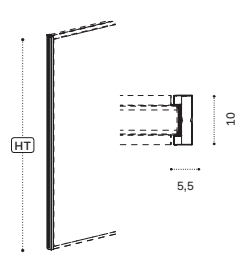

Carter metallico terminale / Terminal metal casing

Accessori/Accessories

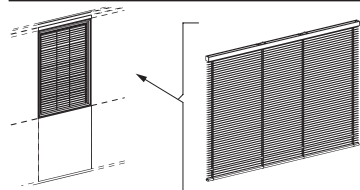

Tendine veneziane/Blinds

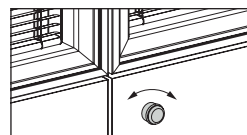

Pomolo per regolazione orizzontale veneziana / Knob for blind horizontal adjustment

Note:

1 Le dimensioni sono espresse in cm - consultare il listino prezzi per le caratteristiche tecniche, i codici degli articoli e delle finiture / Dimensions are stated in cm - for technical characteristics, article code numbers and finishing see price list;

2 Le pareti divisorie DV604 possono essere abbinata alle pareti attrezzate DV605 / The DV604 partition wall systems can be combined with the DV605 ones.